

Allegato I
Planimetria dell'immobile

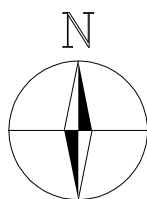

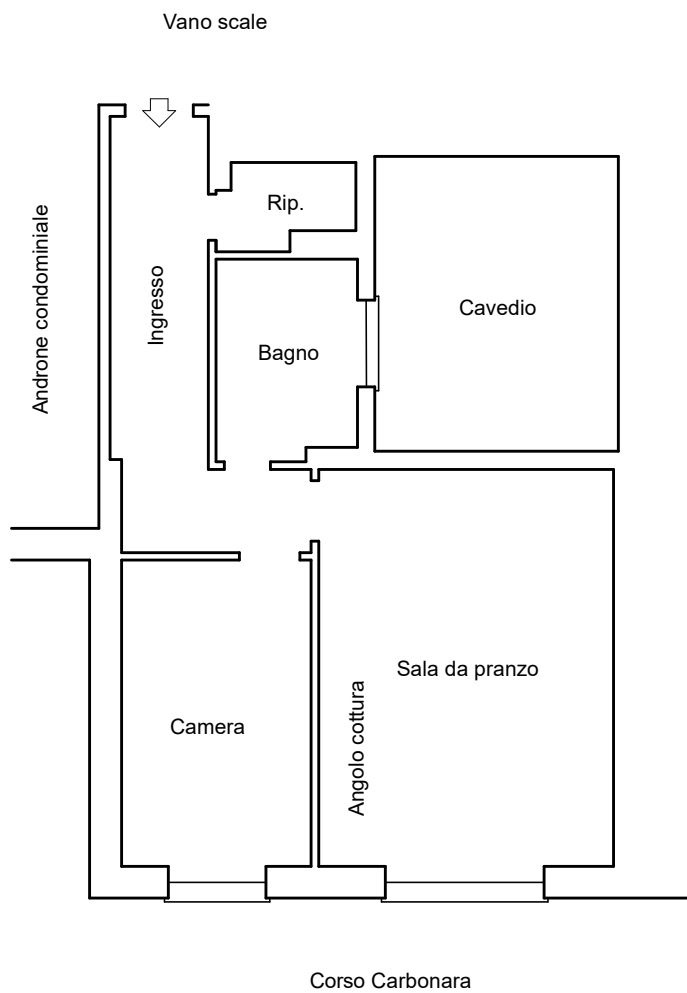

| | |
|---|--------|
| Studio Tecnico Geom. Piero Mattei Via Talamone 12/22 - 16127 Genova GE Tel. 338/52.55.892 e-mail info@geompieromattei.it | |
| Committente: Tribunale di Genova Esecuzioni Immobiliari | |
| OGGETTO: Stato attuale Corso Carbonara 9A/4 scala D | |
| Scala 1:100 | Tav. U |

